

Vehicle Video Recorder

AP-MPF01

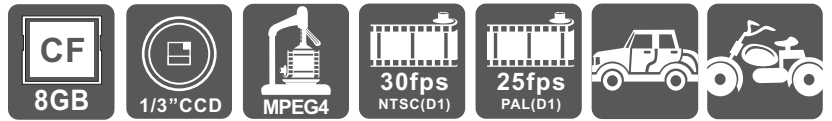

Example for car



Example for heavy motorcycle
(This unit is not waterproof, please take care of using it)

KEY FEATURES

1. Built-in 1/3" SONY CCD & DSP element.
2. High resolution, Low lux, high -speed reaction, much more advanced than CMOS type.
3. High image quality with good performance.
4. MPEG4 compression format, minimum video file capacity.
5. Full digital signal transmission, and the least distortion.
6. High performance compression chip, providing high quality & fast reaction in image. (30 D1/SEC NTSC).
7. The image is stored with CF card, vibrations free totally while vehicle being driven.
8. Video image can be viewed simultaneously when connect to monitor.
9. Complete record of time /date can be shown on the screen while is on the process of playback.
10. Complete recording event lists provided and easily to be searched.
11. Friendly use for operation of PC viewer.

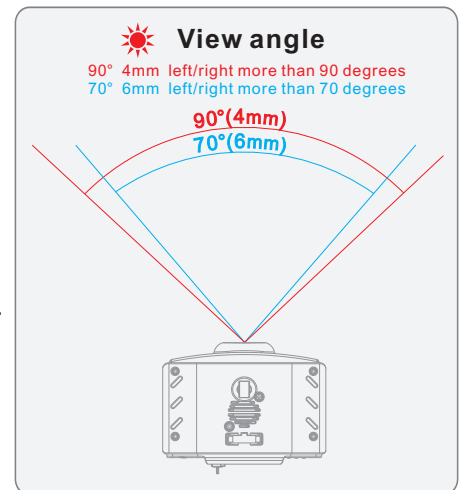

Structure of product

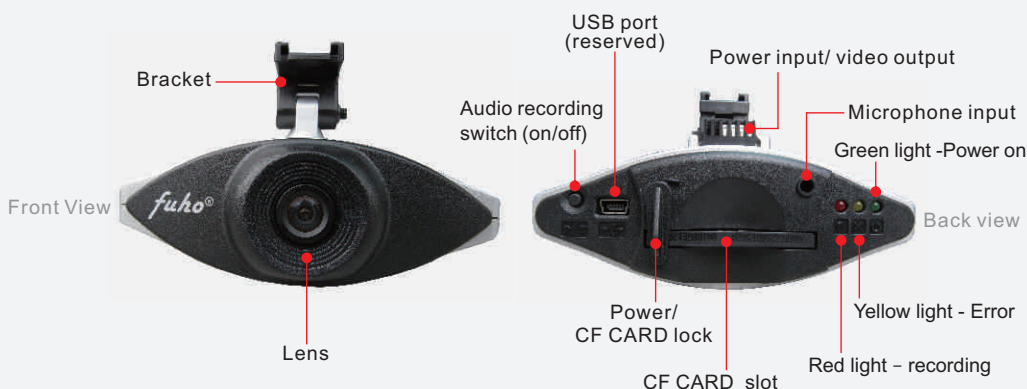

Assembly diagram

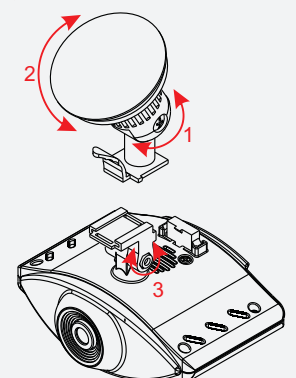

Vehicle Video Recorder

PC VIEWER operational instruction

Viewing Window
A snapshot of actual view.

Starting Time
ID
Ending Time

Event Selected

Month Selected
Date Selected

Fast Forward
Audio On/ Off
Switch

Hour
Minute

Searching Bar
Play/ Pause
Backup
Min the player
Slow Forward
Bit Rate On/ Off
Frame Rate On/ Off
Snapshot

Record of event
The data between records
No data

SPECIFICATION

Lens device	1/3" Super Had Sony CCD, digital output
View angle	4 mm Left/Right more than 90 degrees / 6mm Left/Right more than 70 degrees
Voltage	DC11V~ 14.5V
Operating Temp.	0 ~ 40 degree C (vehicle inside)
Storage device	CF Card
Audio/Video recording mode	a.Directly force audio/video recorded after switching on b.Video-MPEG4 compression format c.Audio - PCM format recording
Resolution	720x480 (NTSC)
Recording Frame	D1 30 fps (NTSC)
Recording content	Date , Time , Image, Sound
Indicator lamp	a. Red(Slow flashing - both video& audio recorded, fast flashing - video recorded only) b. Yellow (Error) c. Green(Power on)
Control button	Audio recording(on/off)
Alarm	Buzzer(trouble warning)
Installation	Fixed on windshield by sucking disc
PC Viewer	Based on Windows system
Microphone	External MIC
Accessory	CF Card (8GB)、 Disc(operational manual、 PC viewer)、 Operation manual(Paper copy)、 Cable material、 Card reader、 Collar -buckle MIC.
Firmware upgraded	Upgraded via CF CARD
Output/Input interface	a. DC12V input, video output b. CF Card Slot c. Microphone 3.5mm connector